



# PLANNING DEPARTMENT

120 W. Dougherty Street • Athens, Georgia • 30601

## MEMORANDUM

---

TO: Athens-Clarke County Mayor and Commission  
FROM: Rick Cowick  
THROUGH: Brad Griffin  
DATE: November 15, 2016  
RE: Proposed partial demolition of house at 420 Woodward Way

---

The proposal is to partially demolish the house at 420 Woodward Way by altering a portion of the exterior front wall for a front addition. As per Section 9-4-15C, Staff has found this proposal eligible for a complete 90-day demolition review. As the application was submitted on November 14, 2016, written request to continue the review is needed by December 9, 2016 from the Commissioner elected to represent the subject property.

The subject property falls within Commission District #7 – Diane Bell

The following additional information has been provided by the applicant or noted through Staff research:

**Property Address:** 420 Woodward Way  
**Parcel Tax Map#:** 124D3 D002  
**Property Zoning:** RS-25 (Single-Family Residential)  
**Applicant:** John Newland / JOMA Construction  
Telephone: 706-372-1052  
Email: john@jomaconstruction.com  
**Owner:** Elena Brown & Jared Harper

The applicant and tax assessor information indicate 1955 as the construction date of the house. The property is not in a National Register Historic District or within a potential local historic district listed in the Comprehensive Plan.

Attached are a location map, photograph of the subject property, and proposed site plan.

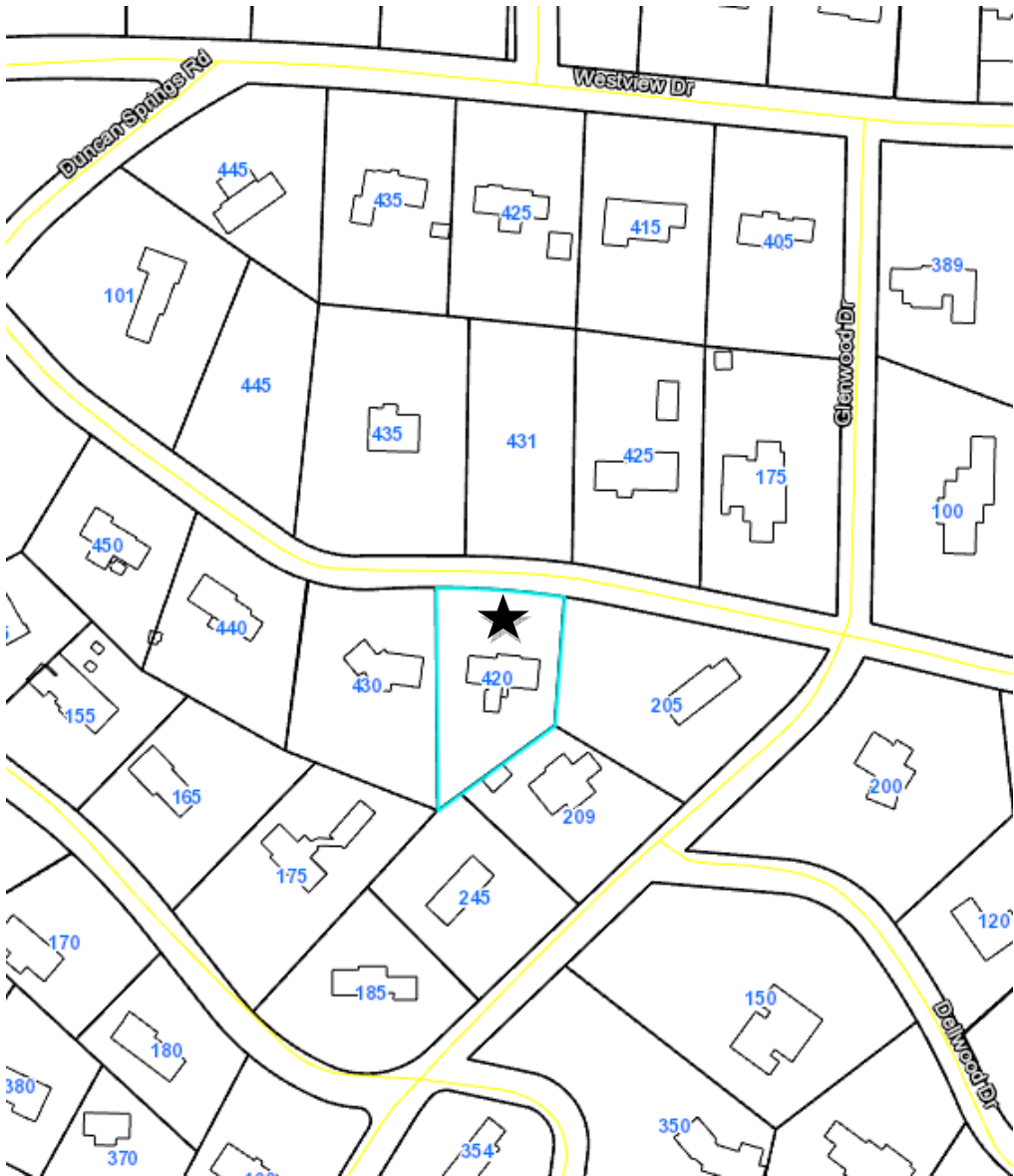

420 WOODWARD WAY

SCALE 1:40

LOT SIZE: 29,185 square feet

NO CHANGE TO EXTERIOR LIGHTING

LOT COVERAGE: 17.8%

HOUSE 2916 SF

DRIVE 1850 SF

WALK 450 SF

LOT COVERAGE PROPOSED: 19.5%

HOUSE 3399 SF

DRIVE 1950 SF

WALK 450 SF

